





Burn Side, Hoddesdon, EN11 8PG

Westwood Leber is pleased to present this impeccably maintained three/four bedroom end-of-terrace townhouse, ideally situated in the heart of Hoddesdon. This property boasts excellent living space, featuring a spacious kitchen, a combined lounge/diner, a downstairs WC, a separate living room (or potential fourth bedroom), three generously sized double bedrooms, and a family bathroom. Additional advantages include off-street parking for two vehicles and a sizable rear garden. Early internal viewing is strongly advised.



WESTWOODLEBER

WESTWOODLEBER
LET US GUIDE YOU HOME

Ground Floor

Approx. 37.8 sq. metres (407.3 sq. feet)

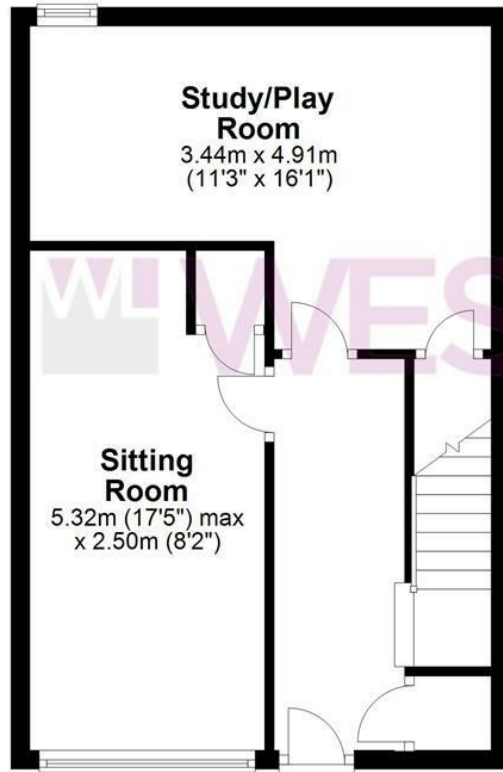

First Floor

Approx. 37.8 sq. metres (407.3 sq. feet)

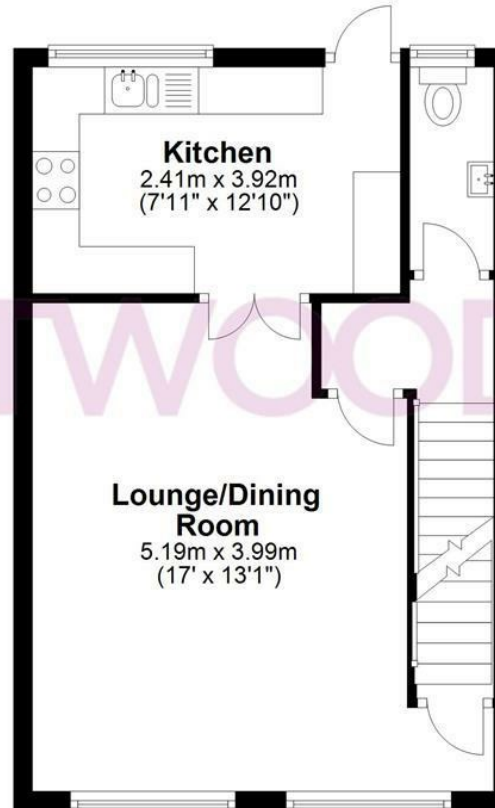

Second Floor

Approx. 37.8 sq. metres (407.3 sq. feet)

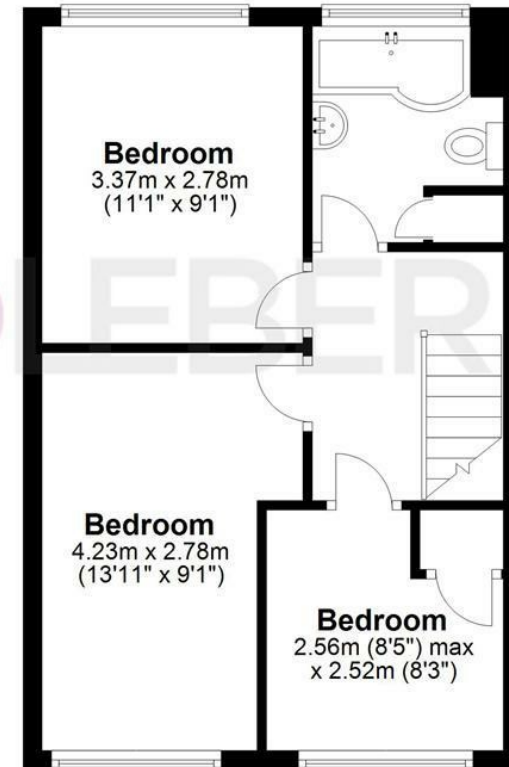

Total area: approx. 113.5 sq. metres (1221.8 sq. feet)

THE FLOORPLAN IS FOR ILLUSTRATIVE PURPOSES ONLY AND IS NOT TO SCALE. Measurements and features are approximate and may differ from the actual property. Verify all details independently; no liability is accepted for errors or omissions.

Property marketing provided by www.fotomarketing.co.uk









